

## [705] TARAFLEX™ COMFORT

### INSTALLATION GUIDELINES

The foam of the Taraflex™ COMFORT can be completely glued if the concrete slab have an effective moisture vapor barrier and the substrate moisture levels shall not exceed 5 lbs / 80% RH.

#### ■ 1 - SUBFLOORS

Glued installation over a Taraflex™ Comfort foam underlay does not preclude preparing the subfloor to make it FLAT, SMOOTH and SOUND: please see the sections on "recommendations according to subfloors and advice on identifying and preparing subfloors" in the Dry-Tex™ installation guide.

**Do not install SPORT M COMFORT on a radiant heating subfloor.**

Gerflor accept humidity in the slab up to 4.5% at 4cm with the Carbide Moisture Test or < 5 lbs/1000 sq.ft / 24 h with the ASTM F1869 or > 80% RH with the BS 8203 (ASTM F2170).

##### 1.1 - SUBFLOORS with no risk of humidity < 4.5% (CCM), 80% RH:

Types of concrete on stage, paving in floor, on crawlspace, on casing, ... The installation may be carried out, according to the local standards, by gluing the foam.

##### 1.2 - SUBFLOORS with humidity over 4.5% (CCM) or 8 lbs/1000 sq.ft / 24 h with the ASTM F1869 or 80% RH with the BS 8203 (ASTM F2170):

Taraflex COMFORT can be installed on Epoxy resin barrier.

#### ■ 2 - FLOORING MATERIALS

Slight width differences (tolerances) may exist from one sheet to the next.

- 5 mm-thick Sport M Comfort foam underlay
- Taraflex™ Sport Evolution

Before installing the flooring materials, inspect thoroughly to detect any visual defects.

In the event of a visual defect, the installation contractor is responsible for informing Gerflor about it before laying work begins.

#### ■ 3 - ROLLING OUT THE 5 MM-THICK SPORT M COMFORT FOAM UNDERLAY FOR THE TARAFLEX™ SPORT M COMFORT SYSTEM (46 m X 1.50 m)

**HANDLE WITH Nitrile or rubber gloves to avoid electrostatic discharge.**

During the installation of the foam, it should be examined, and to detect any problem. In case of default, we ask you to inform GERFLOR and not to start the implementation without its agreement.

Be careful, keep the label produced because it will be required in case of complaint.

Be sure to respect the optimal time of use of the foam, which is the DATE TREATED, DATE OF TREATMENT (indicated on the red badge) + 1 YEAR.

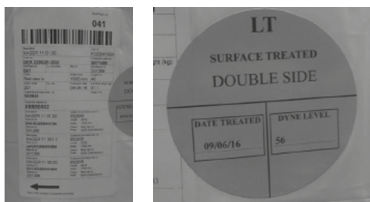

#### STORAGE CONDITIONS:

The foam must be stored in enclosed, ventilated rooms, protected from humidity and at a room temperature of 20°C or higher.

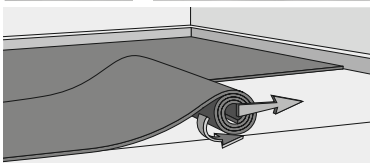

#### 3.1 Laying conditions

- Minimum indoor temperature must be above 10°C.
- Minimum floor temperature must be 10° C.
- The temperature range for adhesives is +10°C to +30°C.
- When installing, indoor temperature must be at least + 10° C and

at least 3° C above dew-point (when atmospheric moisture starts condensing on the substrate).

#### 3.2 Rolling out the 5 mm-thick Sport M Comfort foam underlay for the Taraflex™ Sport M Comfort system (width 1.50 m)

Strike the longitudinal and transversal axis between the anchor points. Strike a parallel line with a 75 cm offset to the length axis.

Place the foam underlay against this line and roll it out lengthwise edge to edge. The sheets will be positioned starting from the wall and rolled out along the longitudinal axis. **Head joints are not permitted on the main area. If the length of the room is less than 46 m, cut the foam and discard the excess.**

#### ■ 4 - STICKING-DOWN

- This is done 12 hours after having unrolled and laid out the lengths.
- The application is be done by priming and using acrylic emulsifying adhesives or pressure sensitive adhesive with a finely toothed spatula or trowel A2 Norm TKB or 1/16" x 1/16" x 1/16" square notch (1.6 mm x 1.6 mm x 1.6 mm). Coverage rate is 300 to 350 gr/sqm or 125 - 185 sq. ft. per US gallon, (3.06 - 4.53 m<sup>2</sup> per liter). To achieve this coverage, it is necessary to change the spatula regularly.

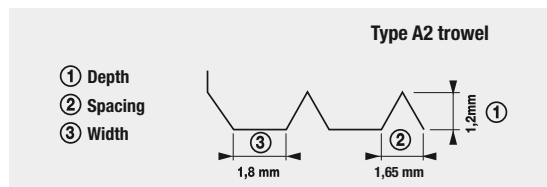

#### Recommendations for good adhesion:

- Respect the waiting time (open time) which depends on the temperature, ambient hygrometry, porosity of the subfloor and the adhesive coverage.
- If the flooring is applied to adhesive with insufficient waiting time, it will bubble.
- If the flooring is applied to adhesive which has gone past its open time, there will be insufficient adhesive transfer to the underside of the floor finish.

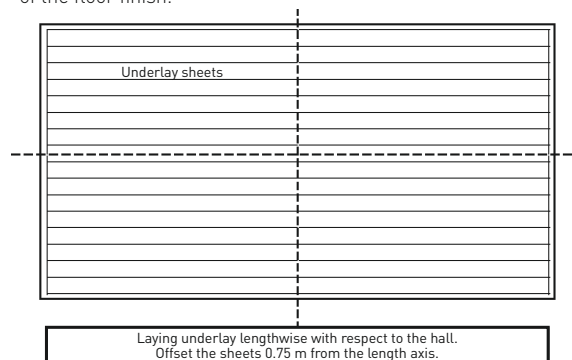

- The length of the foam rolls allows to not have any butt or header joints in the gym.
- In case of excessive thickness on the red foam butt joints, trim it with a Mozart or straight-bladed knife.

#### Recommendations for gluing

Carefully observe tack time, which depends on the temperature, relative humidity, substrate porosity and consumption.

NB: Regularly check trowels or rollers for wear and change as often as required to maintain glue or adhesive consumption at the recommended value.

Clean (fresh) glue spillages and tools with water or a thinner recommended by the manufacturer.

# [705] TARAFLEX™ COMFORT

## INSTALLATION GUIDELINES

### ■ 5 - ROLLING THE UNDERLAY

Rolling is compulsory and necessary to provide correct transfer of the acrylic.

Rolling is performed in two stages:

Manual bubble removal at the time of application using a cork wedge.  
Rolling of glued areas ONLY using a 50 kg roller.

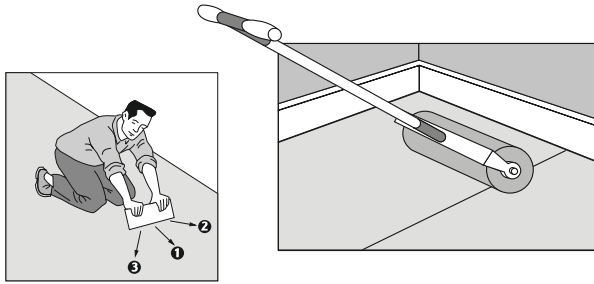

Joints do not require sealing by hot or cold welding.

### ■ 6 - ROLLING OUT TARAFLEX™ EVOLUTION

#### 6.1- Laying conditions

Minimum indoor temperature must be above 10°C.

#### 6.2- Rolling out Taraflex™ Evolution

- To carry the rolls of Taraflex™ Sport, use a trolley equipped with inflated tyres. Do not leave the rolls stood up on end.
- Strike the lengthwise axis on the foam underlay as shown below.
- Roll out the sports flooring material along the length axis.
- Leave 1 cm between each roll.
- The end of the material near the cardboard tube core must be placed along walls.

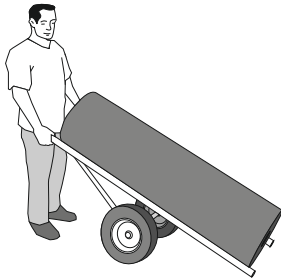

#### 6-3- Laying the flooring material

The next day, the rolled out sheets of Taraflex™ Sport M Evolution material can be laid along the axis leaving 1 mm between sheets before gluing.

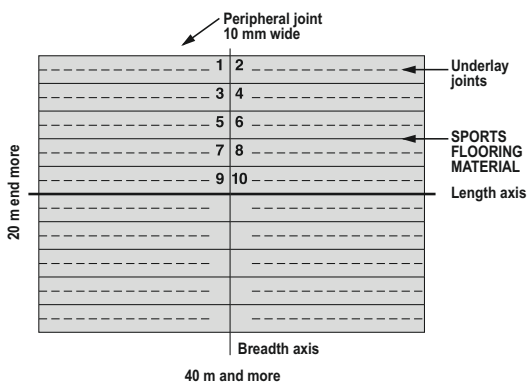

### ■ 7 - GLUING - Acrylic gluing (Compact / Compact)

Use a compact / compact acrylic glue for compact / compact coverings.

#### 7.1- Glue application

Glue is applied 24 hours after positioning the sheets. Acrylic emulsion glue is applied single spread using a fine-tooth trowel A4 Norm TKB or 'U' notch 1/32" x 1/16" x 1/32" (0.8 mm x 1.6 mm x 0.8 mm) At a rate coverage of 150 to 200 g/sqm (185 - 245 sq. ft. per US gallon (4.53 - 6.0m<sup>2</sup> per litre). Use after covering the glue a short-pile wool paint roller. The spread rate depends on glue density.

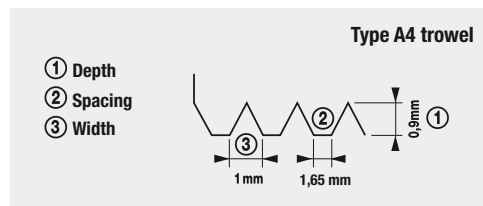
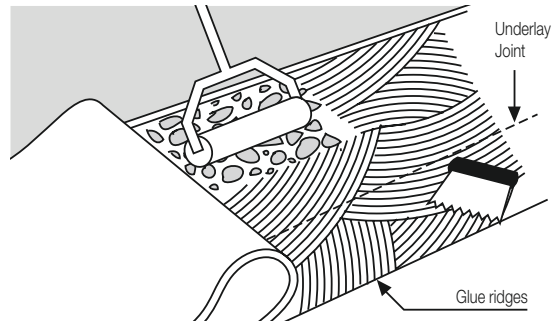

To ensure correct tack time and to eliminate water, it is absolutely vital to flatten the ridges of glue during application using a medium-pile wool roller.

This operation eliminates water, which may re-disperse the glue. It is essential to wait for the glue to fully tack. Room temperature and relative humidity can have a significant effect on tack time. To accelerate tack time, we recommend that you ventilate the hall using appropriate means (blower, fan).

#### Recommendations for gluing:

As the glue is designed for bonding impermeable / impermeable materials, it is vital to wait for the film of glue to tack fully. Insufficient tack time will cause bulges to form.

#### 7.2 Laying the sheets

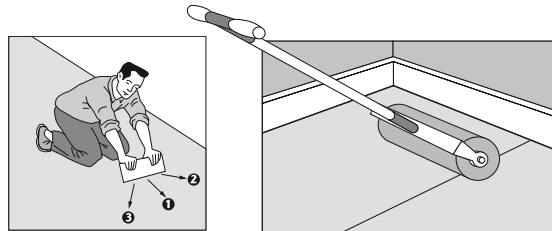

Fold back the sheets halfway to apply glue. Begin application with the central half-sheets on either side of the length axis. Fold back the second halves and proceed likewise, then apply to the neighbouring sheets edge to edge leaving a gap of 1 mm + or - 0.5 until reaching the walls.

### ■ 8 - ROLLING THE MATERIAL

Rolling is compulsory and is performed in two stages:

- Manual bubble removal at the time the sheets are laid.
- Rolling the entire surface several times using a roller no sooner than 1 hour after gluing, working outwards from the breadth axis.

# SPORTS FLOORS

## [705] TARAFLEX™ COMFORT INSTALLATION GUIDELINES

### ■ 9 - HEAT WELDING (12 HOURS LATER)

#### 9.1 Routing / Grooving

Routing provides open, regular joints and removes any traces of glue detrimental to weld quality.

Two routing methods may be used:

- manual, using an appropriate tool (triangle, ruler)
- mechanical, using an electric router fitted with a 3.3 to 3.5 mm countersink cutter.

Rout out the entire thickness of the wear layer but do not penetrate into the foam.

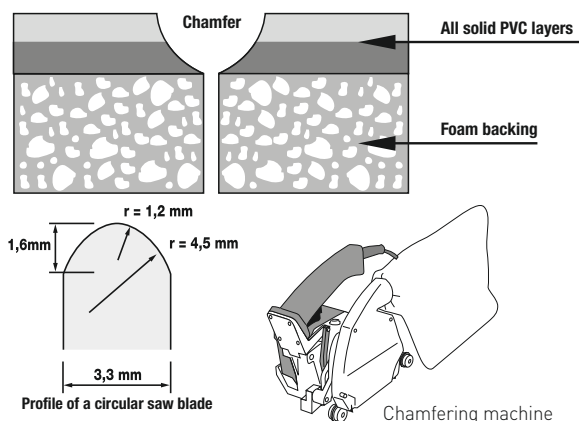

#### 9.2 Automatic welding machine

Use a LEISTER UNIVERSAL or UNIFLOOR-type machine with a variable temperature hot air gun and a specially designed multi-outlet nozzle.

Nozzle part number:

JANSER: 225 860 300

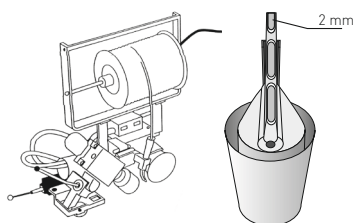

LEISTER: 105 407

#### 9.3 Trimming weld rod

Trimming must be done in one pass.

Using a trimming tool sharpen in the middle only, such as the Mozart, is recommended.

Trimming must be done with the trimmer only.

This method prevents concave welds and must be done when the rod is cold.

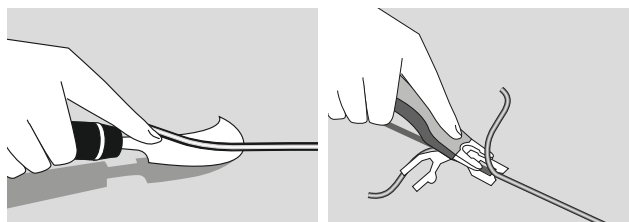

Available from Gerflor - Ref. 0561 0001 - Spare blade - Ref. 0542 0001

### ■ 10 - FINISHING

Accessories are available to achieve attractive trims around openings:

- To avoid level differences the Foam backing / Taraflex™ sports floor material composite will be glued to the cover over the opening.
- Circle cutter fitted with a centring device (ref.: 91653 - ROMUS, part 262 262 500 - Janser)

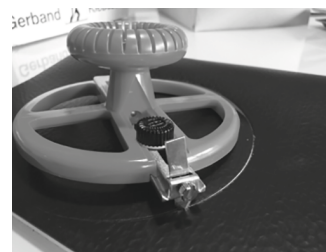

**IMPORTANT: GERFLOR is at your disposal for advice concerning equipment.**

#### IMPORTANT: commissioning deadlines:

- For normal pedestrian traffic, commissioning takes place 24 hours at least after completion of the work.
- For the installation of sports equipment and the traffic of rolling loads it is necessary to wait 72 hours.
- It is necessary to distribute the static and dynamic loads when setting up in the table tennis table room folded or open, referee tables, or use of carts solid storage, removable basketball boards, approved equipment, elevating platforms, forklifts, utilities...

The raceways and distribution plates must be dimensioned and positioned according to the loads.

See [803] STATIC AND DYNAMIC LOAD

Do not use furniture with rubber feet.